

Checktemp-Dip

HI 98501-01 (Checktemp-Dip) **C**: Celsius Model

HI 98510-01 (Checktemp-Dip) **F**: Fahrenheit Model

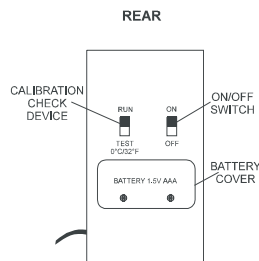
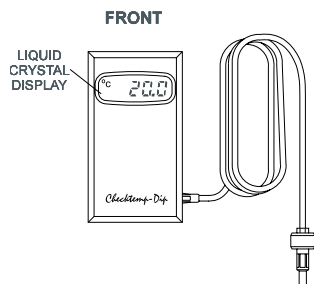

SPECIFICATIONS:

Range

°C -20 to 100.0 &
-60.0 to 0.0°C
°F -4.0 to 199.9°F &
200 to 212°F

Resolution

°C 0.1°C
°F 0.1°F (-4.0 to 199.9°F)
1°F (200 to 212°F)

Accuracy

°C ±0.5°C (-20 to 50°C)
±0.9°C (outside)
°F ±0.9°F (-4 to 122°F)
±2°F (outside)

Environment 0 to 50°C (32 to 122°F);
95% RH max.

Battery Type 1 x 1.4V alkaline
Life approx. 3,000 hours
of continuous use

Dimensions 106 x 58 x 19 mm
(4.2 x 2.2 x 0.7")

Weight 80 g (2.8 oz.)
Probe Stainless steel,
Wrigled down probe
with 3 meter (10') cable

SUGGESTIONS FOR USERS:

Before using this product, make sure that it is entirely suitable for the environment in which it is used. Operation of this instrument in residential areas could cause interference to radio and TV equipment. Any variation introduced by the user to the supplied equipment may degrade the instrument's EMC performance. To avoid electrical shocks, do not use this instrument when voltage at the measurement surface exceeds 24 VAC or 60 VDC. To avoid damage or burns, do not perform any measurement in microwave ovens.

Visit our Internet Home Page:
<http://www.hannainst.com>



Manufacturers since 1978

Checktemp-Dip

OPERATION:

- Turn Checktemp-Dip on.
- Dip the probe in the sample. An immersion level of at least 4 cm (1 1/2") is recommended.
- Do NOT wrench the probe. If the cable is damaged, the meter may have to be replaced.
- Wait for a few seconds for the display to stabilize and switch the meter off when not in use.
- Variations in readings or fading display can indicate a weak battery.
- Checktemp-Dip is not suitable for continuous measurement (in-line, especially at high temperatures) and should only be used for spot checks.

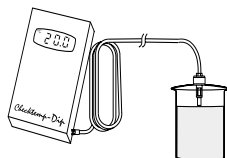
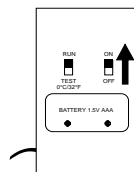

- Even though Checktemp-Dip can reach 100°C, prolonged measurements at high temperatures will reduce the sensors life dramatically. Ideally operate in the -20 to 50°C (-4 to 120°F) range.

CALIBRATION CHECK SWITCH:

Move the Cal-check switch down. The display should show 0.0°C ±0.5°C or 32°F ±0.9°F. Contact your dealer or your nearest Hanna Service Center for recalibration, if necessary. Move the Cal-check switch back up and the display will return to measurement mode.

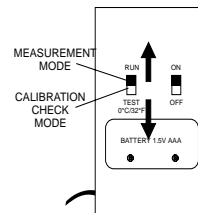

BATTERY REPLACEMENT:

When Checktemp-Dip cannot be switched on or the display fades, remove the two screws, open the battery cover and change the

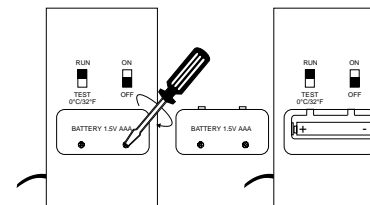

1.4V AAA battery, paying attention to its polarity. Replace the cover and tighten the two screws. Battery should only be replaced in a safe area using an alkaline 1.5V AAA type battery.

ISTFCHT1R1 03/2000