

**ACCESSORIES:**

**Probe EPW:** penetration/general purpose probe

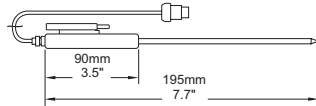

**Probe ELW:** liquid/general purpose probe

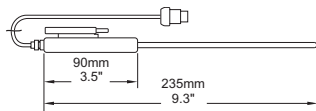

**Probe ECW:** air/gas probe

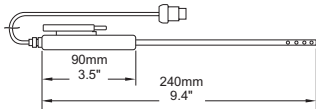

**Probe EMW:** surface probe

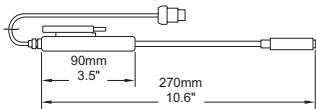

**SUGGESTIONS FOR USERS:**

Before using this product, make sure that it is entirely suitable for the environment in which it is used. Operation of this instrument in residential area could cause unacceptable interferences to radio and TV equipments, requiring the operator to take all necessary steps to correct interferences. Any variation introduced by the user to the supplied equipment may degrade the instrument's EMC performance. To avoid electrical shock, do not use this instrument when voltages at the measurement surface exceed 24VAC or 60VDC. To avoid damages or burns, do not perform any measurement in microwave ovens.

**HANNA instruments** Visit our Internet Home Page:  
<http://www.hannacan.com>

---

**Instruction Manual**

---

**HI 149-00**  
**HI 149-01**

**Remote Probe  
Thermometer**

**Foodcare**

---

**HANNA**  
instruments

*Stay in Touch with the Manufacturer!*



**HI 149** is a portable K-Type thermocouple thermometer for routine use in food industry applications.

With four probes to choose from, **HI 149** can be used in most applications including air & gases, liquids, surfaces and semi-solids. Each probe has a stainless steel shaft that resists the harmful effects of chemicals.

**HI 149** is available in Celsius (**HI 149-00**) and Fahrenheit (**HI 149-01**).

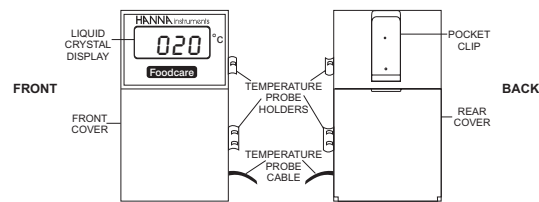

**OPERATION:**

- Connect one of the four probes (see accessories) by opening the rear cover and by inserting the 3-pin probe connector into place
- To switch the HI 149 on, slide off the front cover and push the ON/OFF switch upwards to the "ON" position.
- The temperature will be displayed in either °C or °F depending on the model used.

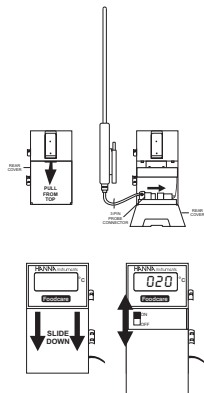

- To exchange the probe, open the rear cover of the unit and release the probe connector prior to inserting the new probe.
- When not in use, switch the **HI 149** off.
- Variations in readings or fading display can indicate weak batteries.

**BATTERY REPLACEMENT:**

When the HI 149 cannot be switched on or the display fades, pull out the rear cover, remove the battery cover and replace all the three 1.5V batteries, paying attention to their polarity.

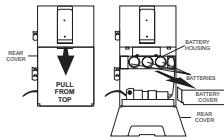

Batteries should only be replaced in a safe area using the battery type specified in this instruction sheet.

**SPECIFICATIONS:**

	HI 149-00(°C)	HI 149-01(°F)
<b>Range</b>	-40 to 300°C	-40 to 572°F
<b>Resolution</b>	1°C	1°F
<b>Accuracy</b>	±2°C	±4°F
<b>Typical EMC Deviation</b>	±2°C	±4°F
<b>Probe</b>	stainless steel probe (interchangeable) with 1m cable	
<b>Battery Type</b>	3 x 1.5V	
<b>Battery Life</b>	Approx. 700 hours of continuous use	
<b>Dimensions</b>	106x68x21mm (4.2x2.7x0.8")	
<b>Weight</b>	80g (2.8 oz.)	